



PUBLIC NOTICE

US Army Corps
of Engineers
Rock Island District

Applicant: Mr. Ross Weymiller

Date: December 22, 2020

Expires: January 20, 2021

CEMVR-RD-2020-1655

Section 404

Joint Public Notice
US Army Corps of Engineers
Iowa Department of Natural Resources

1. **Applicant:** Mr. Ross Weymiller, 1261 Hartley Drive, New Albin, Iowa 52160.

2. **Project Location:**

- Shoreline on the Upper Iowa River
- Section 31, Township 100 North, Range 4 West
- Allamakee County, Iowa
- UTM NAD-83 Zone15
- Lat 43.434873, Long -91.367157.

3. **Project Description and Purpose:** The applicant proposes to stabilize 2,785 linear feet of the eastern bank on the Upper Iowa River. The existing river bank exhibits nearly vertical, actively eroding slopes. The applicant is receiving assistance from the local NRCS office (West Union, Iowa) and plans to utilize Iowa DOT Class B riprap to stabilize the entire 2,785' portion of river shoreline. The purpose of this project is to minimize future erosional damage, prevent the loss of land or land uses adjacent to the Upper Iowa River due to anticipated future high water events, and minimize fine sediments that are currently being washed downstream of the project area. Wetland impacts are not anticipated.

4. **Avoidance and Minimization:** The applicant's original project plans to minimize impacts to Waters of the United States by applying riprap only on the eastern shore and not both shorelines of the Upper Iowa River within the project area. The only avoidance measures considered by the applicant are "No Action" and "Proceed as originally planned." The applicant's project description and purpose are meant to improve flood resiliency and if allowed to proceed as planned should decrease unwanted sediment deposits while simultaneously increasing water quality of the Iowa River. Stream mitigation will not be required due to the nature of the project.

5. Agency Review.

a. Department of the Army, Corps of Engineers. The Department of the Army application is being processed under the provisions of Section 404 of the Clean Water Act (33 U.S.C. 1344).

b. State of Iowa. The project plans have been submitted to the Iowa Department of Natural Resources (IDNR) for state certification of the proposed work in accordance with Section 401 of the Clean Water Act. The certification, if issued, will express the Department's opinion that the proposed activity will comply with Iowa's water quality standards (Chapter 61 IAC). The applicant has also applied for authorization of work in the floodplain pursuant to Chapter 455B of the Iowa Code and other applicable state permits. Written comments concerning possible impacts to waters of Iowa should be addressed to: Iowa Department of Natural Resources, 502 East 9th Street, Des Moines, Iowa 50319. A copy of the comments should be provided to the Corps of Engineers office (see paragraph 11. of this public notice for address).

6. **Historical/Archaeological.** The Project Manager consulted with the Iowa geographic information systems archeological site and survey databases online, including the HILD layers. The project area has not been surveyed previously. The project area does fall within HILD layers 416 and 428. Based on the nature of the work (streambank stabilization of an eroding shoreline) it is unlikely to adversely affect any potential cultural or historic resources. The NRCS also made a determination that there are no known sites within the project area. Therefore, it is the opinion of the Project Manager there is low to no potential for intact historic properties to be affected by the proposed action. As such there will be **no historic properties affected** by the issuance of the permit because “the nature, scope, and magnitude of the work, and/or structures to be permitted are such that there is little likelihood that a historic property exists or may be affected” (33 CFR Part 325, Appendix C.3.b).

7. Endangered Species.

a. District staff has performed a preliminary review of this application for the potential impact on threatened or endangered species pursuant to Section 7 of the Endangered Species Act as amended. The following all have potential habitat in Allamakee County, Iowa.

- Northern Long-eared bat (*Myotis septentrionalis*),
- Higgins Eye Pearlymussel (*Lampsilis higginsii*),
- Sheepnose Mussel (*Plethobasus cyphus*),
- Northern Wild Monkshood (*Aconitum noveboracense*),
- Prairie Bush-clover (*Lespedeza leptostachya*),
- Western Prairie Fringed Orchid (*Platanthera praeclara*)

b. No critical habitats are listed within the project area. The project area is on the shoreline of the Iowa river, away from possible habitat for listed Mussel species (Mississippi River). The project area also contains minimal trees, likely not suitable bat habitat. Our preliminary determination is that this project is “**no effect**” to federally endangered species or critical habitat. We are coordinating this application with the Fish and Wildlife Services through this public notice. Accordingly, our preliminary determination is subject to change should further information become available.

8. **Dredge/Fill Material Guidelines.** The evaluation of the impact of the proposed activity on the public interest will also include application of the guidelines promulgated by the Administrator of the United States Environmental Protection Agency under authority of Section 404(b) of the Clean Water Act (40 CFR Part 230).

9. **Public Interest Review.** The decision whether to issue the Corps permit will be based on an evaluation of the probable impact including cumulative impacts of the proposed activity on the public interest. That decision will reflect the national concern for both protection and utilization of important resources. The benefit which reasonably may be expected to accrue from the proposal must be balanced against its reasonably foreseeable detriments. All factors which may be relevant to the proposal will be considered including the cumulative effects thereof; among those are conservation, economics, aesthetics, general environmental concerns, wetlands, cultural values, fish and wildlife values, flood hazards, floodplain values, land use, navigation, shoreline erosion and accretion, recreation, water supply and conservation, water quality, energy needs, safety, food production and, in general, the needs and welfare of the people.

10. **Who Should Reply.** The Corps of Engineers is soliciting comments from the public; Federal, state, and local agencies and officials; Indian Tribes; and other interested parties in order to consider and evaluate the impacts of this proposed activity. Any comments received will be considered by the Corps of Engineers to determine whether to issue, modify, condition or deny a permit for this proposal. To make this decision, comments are used to assess impacts on endangered species, historic properties, water quality, general environmental effects, and the other public interest factors listed above. Comments are used in the preparation of an Environmental Assessment and/or an Environmental Impact Statement pursuant to the National Environmental Policy Act. Comments are also used to determine the need for a public hearing and to determine the overall public interest of the proposed activity. These statements should be submitted on or before the expiration date specified at the top of page 1. These statements should bear upon the adequacy of plans and suitability of locations and should, if appropriate, suggest any changes considered desirable.

11. **Public Hearing Requests.** Any person may request, in writing, within the comment period specified in this notice, that a public hearing be held to consider this application. Requests for public hearings shall state, with particularity, the reasons for holding a public hearing. A request may be denied if substantive reasons for holding a hearing are not provided.

12. **Reply to the Corps.** Comments concerning the Corps permit should be addressed to the US Army Corps of Engineers, Rock Island District, Attn: RD (S. Dillard), Clock Tower Building - Post Office Box 2004, Rock Island, Illinois 61204-2004. **Mr. Sean Dillard** may be contacted for additional information at (309) 794-5379 or email at sean.m.dillard@usace.army.mil.

matthew a zehr

Attach
Plan

Mr. Matthew A. Zehr
Chief, Western Branch
Regulatory Division

Aerial Map 2 of 3 – Project Location Map
Aerial Map 3 of 3 – Details of Riprap
Aerial Map 3 of 3 – Erosion Control Details

CEMVR-RD-2020-1655
Project Location Map - Encl 1 of 3

If a cultural resource is identified during construction, stop immediately and notify the local Natural Resources Conservation Service office.

Contractor is required to follow Iowa One Call law.
 IowaOneCall.com or Call 811
 Ticket # _____

Note:
 Landowner shall obtain all Federal, State, and Local permits before construction.
 Beginning and End of Project will be staked by NRCS

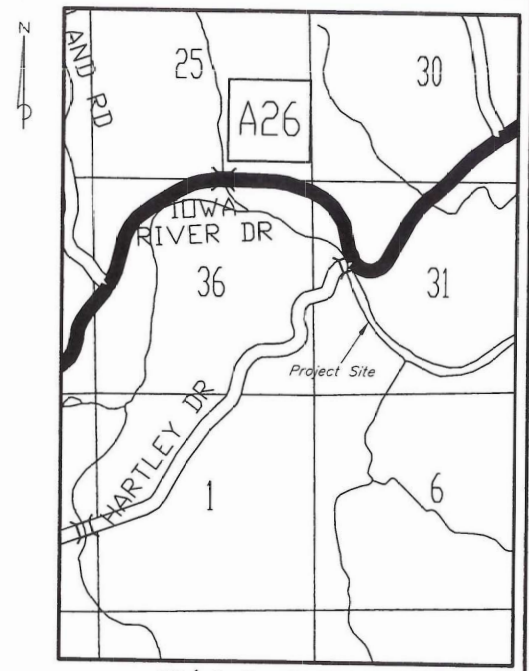

SW 1/4 Section 31 T100N R4W
 Scale 1"=3,000'

Quantities

Stream Bank Length	2,785 Lin. Feet
IDOT Class B Revetment	8,858 Cubic Yards
Excavation	16,220 Cubic Yards
Erosion Control Blanket	4,694 Square Yards
Seeding	0.97 Acres

The following construction specifications are part of this plan:
 IA-1 Site Preparation
 IA-5 Pollution Control
 IA-6 Seeding and Mulching
 IA-21 Excavation
 IA-61 Loose Rock Riprap

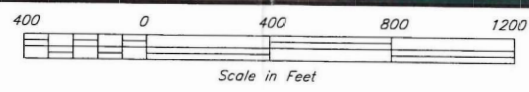

I certify that this practice has been constructed in accordance with the plans and specifications.

Contractor: _____ Date: _____

NRCS Rep.: _____ Date: _____

I have reviewed and agree with the content of the plans and specifications prepared by the NRCS.

Landowner: _____ Date: _____

BENCH MARK		
NO.	ELEV.	DESCRIPTION
TBM #1	647.87	Hub 22' NW Station 0+00
TBM #2	645.81	Hub 82' SW Station 27+00

Date: 3/18/20
 Designed: Dave Mellick
 Drawn: Dave Mellick
 Checked: _____
 Approved: _____

Ross Weymiller
 Stream Bank & Shoreline Protection
 PLAN VIEW
 Upper Iowa River Watershed
 Allamakee County, Ia.

USDA
 Natural Resources Conservation Service
 File No. _____
 Drawing No. _____
 Sheet 1 of 3

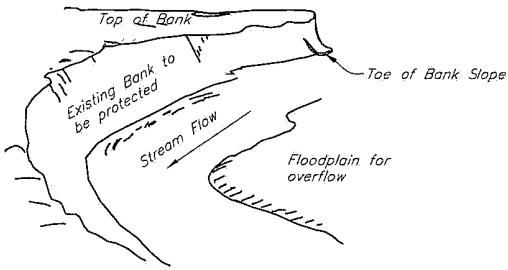

ISOMETRIC VIEW OF STREAMBANK

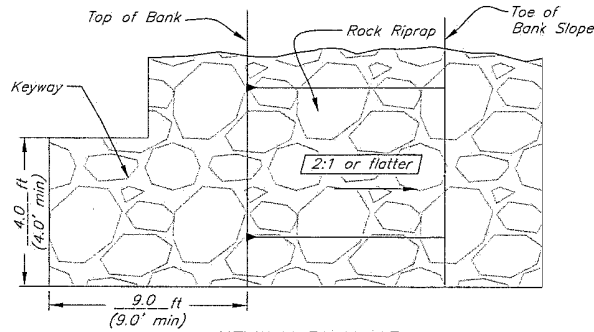

KEYWAY PLAN VIEW

NOTES:

1. Rock riprap shall conform to Iowa NRCS Construction Specification IA-62, LOOSE ROCK RIPRAP.
2. Keyways shall be constructed a minimum of 4 feet thick as measured perpendicular to the design slope. Keyways shall be placed at the upstream and downstream end of the project.
3. Excavated material shall be spread so that it does not serve as a levee.

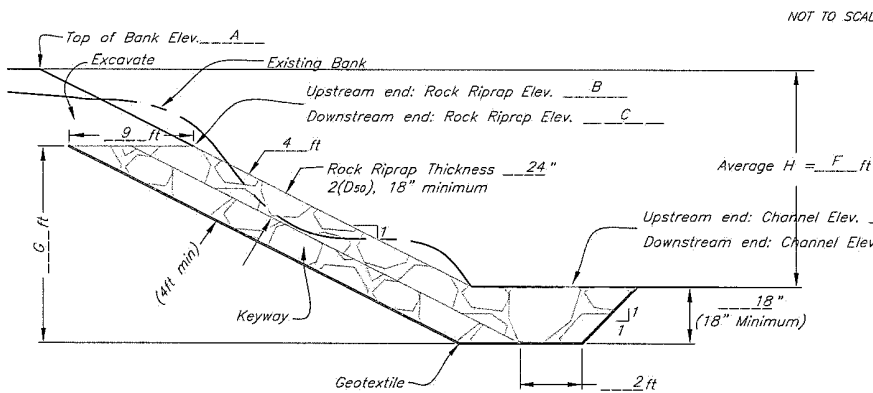

TYPICAL CROSS-SECTION

Option 1

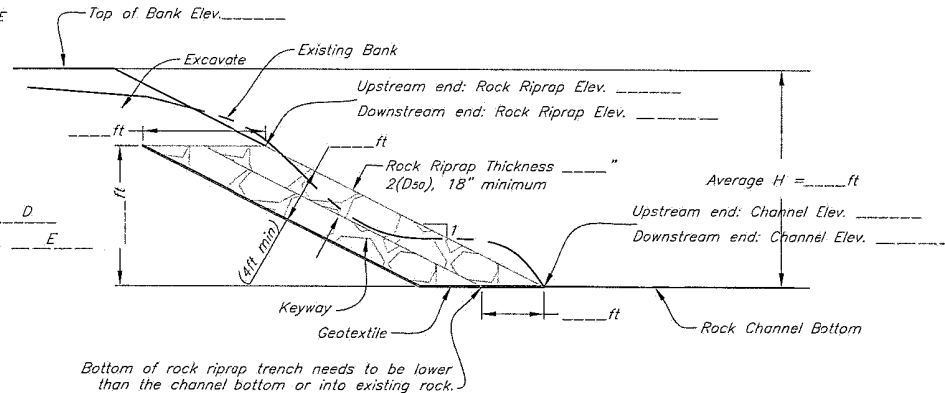

TYPICAL CROSS-SECTION

For use on rock bottom streams only

Option 2

TYPICAL CROSS-SECTION OPTION ?								TABLE OF QUANTITIES				
Site #	Top Of Bank Elevation ("A")	Upstream End Rock Riprap Elev. ("B")	Downstream End Rock Riprap Elev. ("C")	Upstream End Channel Elev. ("D")	Downstream End Channel Elev. ("E")	Average Bank Height In Feet ("F")	Average Riprap Height In Feet ("G")	Linear Feet Of Bank To Be Protected	Cubic Yards of Excavation	Tons of Rock Riprap	Square Yards of ECB	Acres of Seeding
1	648.4	642.0	641.0	626.3	624.0	24.0	18.3	2,785	16,220	13,287	4,694	0.97

* RIPRAP SHALL BE PLACED TO ELEVATION ? OR THE TOP OF BANK, WHICHEVER IS LOWER.

STANDARD DWG. NO. IA-1450-A3

DATE June 2008 SHEET 1 OF 1

Date 3/19/20
 Designed Dave Mellick
 Drawn STANDARD
 Checked
 Approved

DETAILS OF RIPRAP
 BANK STABILIZATION
 Ross Weymiller
 Upper Iowa River Watershed
 Allamakee County, Ia.



File No.
 Drawing No.
 Sheet 2 of 3

CEMVR-RD-2020-1655
Erosion Control Details - Encl 3 of 3

Designed N. Klingenberg Date 5/19
 Drawn N. Klingenberg 5/19
 Checked _____
 Approved _____

Erosion Control Blanket Details

United States Department of Agriculture
 Natural Resources Conservation Service

File No. _____
 Drawing No. _____
 1/13/20 2:20 PM
 Sheet 3 of 3

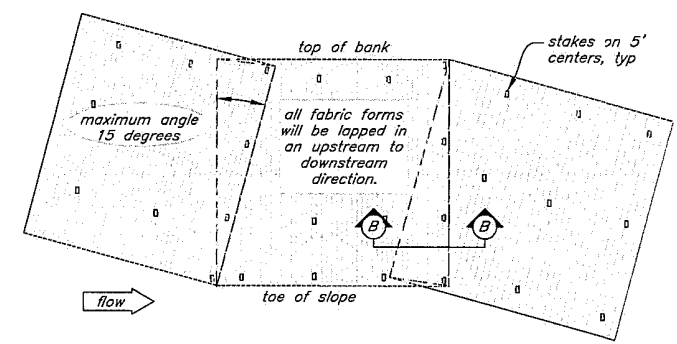
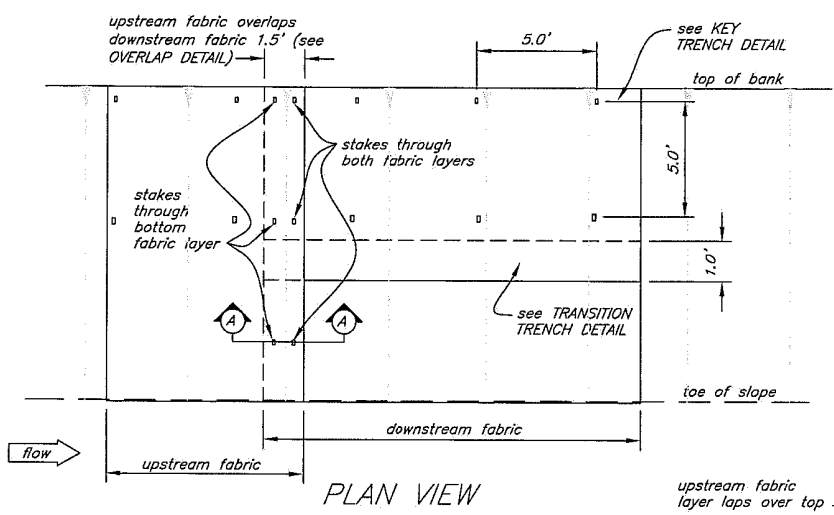

PLAN VIEW FOLDING FABRIC AT BENDS

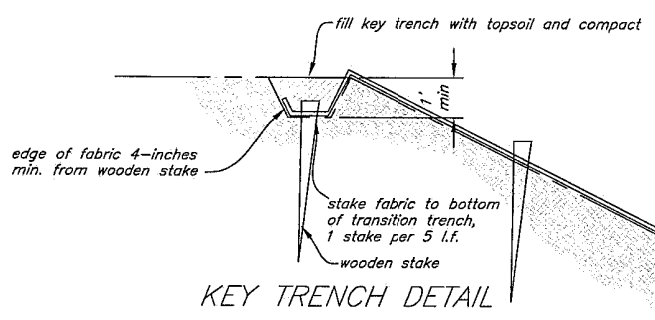

KEY TRENCH DETAIL

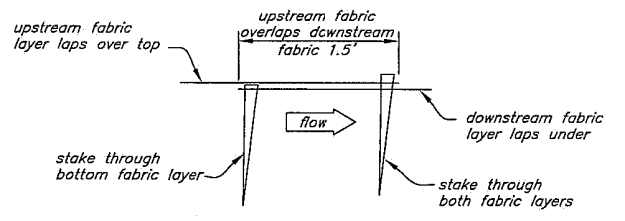

OVERLAP SECTION A

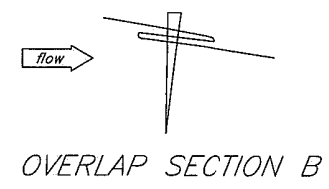

OVERLAP SECTION B

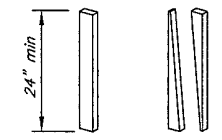

Saw a 2 x 4 diagonally to produce 2 Dead Stout Stakes.

TYPICAL DETAIL STAKE

Toe slope protection to be provided as identified on detail...

This drawing requires supporting technical documentation prior to use and must be adapted to the specific site.

Drawing not to scale.

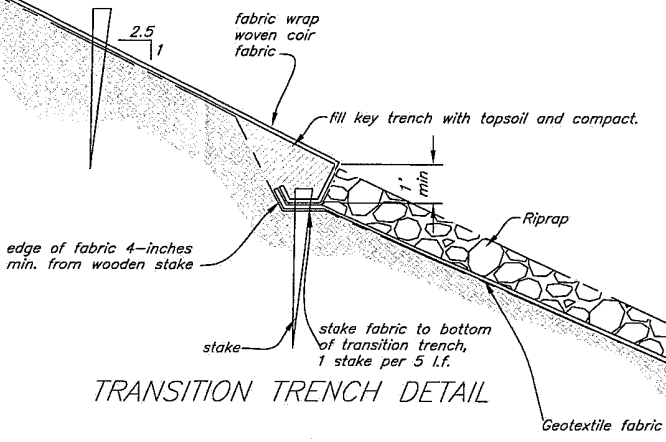

TRANSITION TRENCH DETAIL

GENERAL NOTES

1. Coconut erosion control blanket shall be 'geocoir 700' or approved equal, able to withstand 10 fps water velocities and 4.46 psf shear stress. Fabric embedment 3.0 ft.
2. Prepare soil before installing rolled erosion control products (RECP), including any necessary application of lime, fertilizer and seed.
3. Begin at bottom of the slope by anchoring RECP's in a 1' deep by 1' wide trench. Anchor the RECP with a row of stakes approximately 5' apart in bottom of the trench. Backfill and compact the trench. Apply seed to compacted soil and roll remaining blanket uphill. Anchor last 18" of blanket and first 18" of next blanket (if needed) in 1' deep by 1' wide trench. Repeat process as necessary going up the slope.
4. Use additional stakes as needed to ensure good ground contact.